

Coloured Drinking Fountain Stainless Steel

Product Code DFWHC

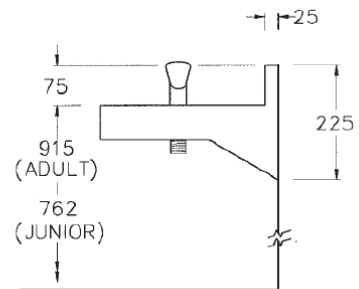
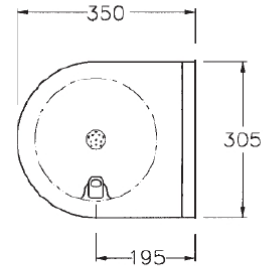

Material:

The drinking fountain is manufactured from 1.6 thick satin polished stainless steel for durability and vandal resistance. Finished with a heavy duty coloured finish baked on at 200 degrees for durability white or black coloured finish as standard, other RAL or BS colours available

Design:

The drinking fountain has a radius front design to eliminate sharp corners and edges which makes it suitable for use in school and public buildings. The unit incorporates integral wall fixing brackets which allow the drinking fountain to be easily installed at adult or junior height.

Fittings:

The drinking fountain comes complete with integral wall fixing brackets, 32mm flush grated waste fitting, and standard NSF approved chrome plated bubbler valve.

Options:

Optional cup / bottle filler instead of the bubbler valve.
WRAS approved bubbler valve (tap)

Alternative Models Available:

Wall mounted drinking fountain with undershroud
Floor standing junior height drinking fountain.
Floor standing adult height drinking fountain.
Floor standing pedestal drinking fountain.
Recessed drinking fountain.

WASHWARE ESSENTIALS LTD

Kestrel Court,,Harbour Road, Portishead, Bristol BS20 7AN, Phone: 01275 390603
Web: www.washwareessentials.co.uk E-mail: enquiries@washwareessentials.co.uk