

Stainless Steel Wash Trough Taplanding Type 480mm Projection

Product Code WTD

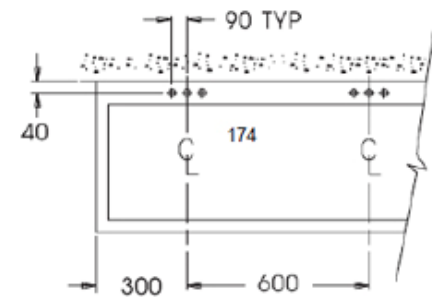
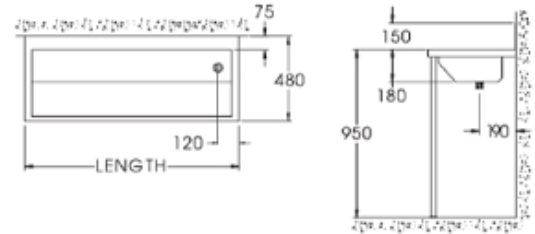

Typical tap hole dimensions and centres

Material:

Manufactured from 1.6mm thick stainless steel with a satin finish. Supplied with stainless steel front support legs as standard.

Length:

The wash trough is available to order online in eight standard lengths: 1200 mm, 1500 mm, 1800 mm, 2100mm, 2400 mm, 2700mm, 3000mm and 3600mm. The wash troughs can also be made to any length up to and including 3600mm.

Fixings:

The wash troughs are supplied as standard with legs and wall bearers. The rear splashback is also pierced with screw holes.

Waste Outlet:

The wash troughs are supplied with a 38 mm (1 1/2") BSP unslotted flush grated waste fitting positioned left or right.

Dimensions:

480mm front to back.
180mm deep with 150mm high integral splashback.

Tap Holes:

The wash troughs can be supplied with tap holes to suit your requirements. Please specify when ordering.

Optional Extras:

Taps, valves and spouts.

WASHWARE ESSENTIALS LTD

Kestrel Court, Harbour Road, Portishead, Bristol BS20 7AN, Phone: 01275 390603
Web: www.washwareessentials.co.uk E-mail: enquiries@washwareessentials.co.uk