

1800mm Trough Urinal - Back or Top Entry

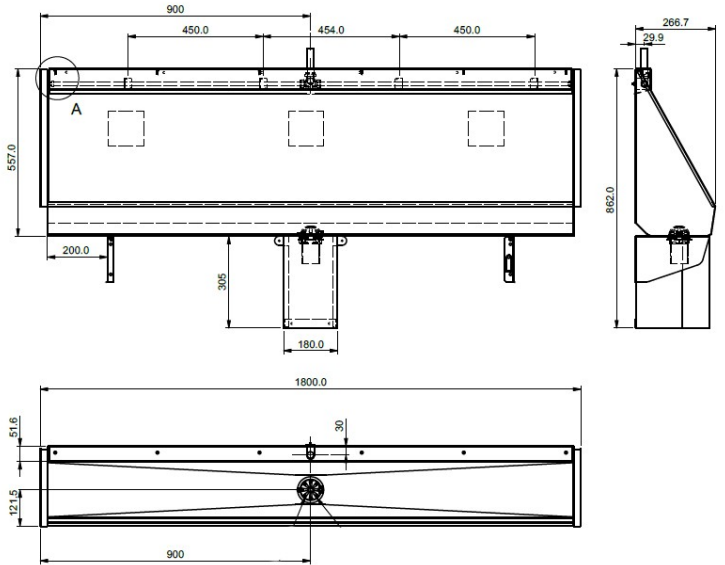

Product Code: TUBT

Stainless Steel Trough Urinal - Back or Top Entry

Product code **TUBT**

1800mm long stainless steel urinal. Engineered for both top and rear water inlet options, this wall-mounted trough urinal is manufactured from premium-grade 1.2mm thick 304 stainless steel with a sleek brushed satin finish. Built for durability and low maintenance, it delivers a clean, contemporary look suited to high-traffic environments such as schools, sports venues, industrial sites, and other commercial facilities. This generously sized urinal ensures user convenience, straightforward installation, and long-term reliability. Each unit is supplied complete with wall mounting brackets, a stainless steel downpipe, a sparge flushing system, a plastic auto-flush cistern, and a 2" domed waste outlet. The sparge pipes can be installed with a top entry connection to suit an exposed surface mounted cistern or rotated 90 degrees to give a back entry connection for a concealed cistern behind the back wall.

- Grade 304 stainless steel for ease of cleaning and corrosion resistance.
- **Last few remaining items all 1800mm long.**
- Central 2" chrome plated brass dome grated waste for compatibility with standard pipework.
- **Plastic auto cistern** and stainless steel downpipe.
- Cistern and downpipe located centrally above the urinal (exposed).
- Durable horizontal sparge pipe flush system, designed to resist vandalism.
- Wall mounted installation for easy cleaning and maintenance.
- Supplied with all essential fittings: cistern, downpipe, sparge pipe, domed waste, and mounting brackets.
- Horizontal sparge pipes to be fitted by installer. Either top entry for exposed cistern or rotated 90 degrees for back entry for a concealed cistern.
- Knock out in top for exposed cistern and removable hole cover in rear for back entry concealed cistern version.
- **Due to the size and weight of the urinals, they will all be delivered on a pallet.**

Delivery

- 1800mm urinals with centre outlets, back and top entry sparge pipes in stock for 1 to 2 working days delivery.
- **Due to the size and weight of the urinals, they will all be delivered on a pallet.**

Size

- Height: 557mm.
- Projection: 266.7mm.
- Length: 1800mm.

Optional Extras

- Marnic Water Watch flush controller.
- Stainless steel trap cover.

****All pictures shown are for illustration purpose only and may be subject to change without notice. Actual product may vary due to product enhancement. All dimensions shown are for guidance only and may be subject to change or alteration without notice. All items manufactured or purchased separately from a third party to fit our products should be checked against the actual dimensions of the physical product before purchase. We will not be liable for third party costs and consequential loss associated with the items not fitting third party components.****