

Floorstanding Sluice Sink - Back Entry

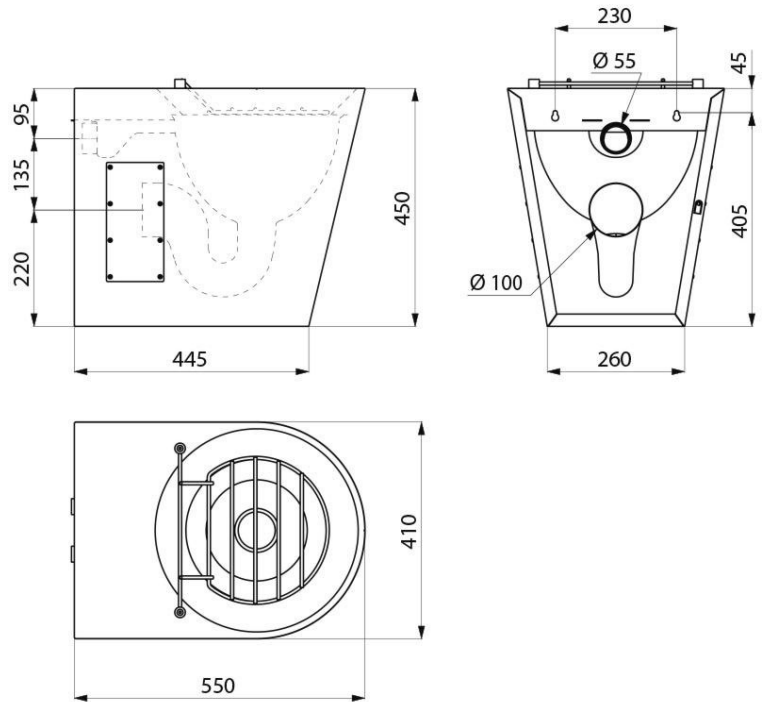

Product Code: DUFS

Floorstanding Sluice sink

Product Code DUFS

The Washware Essentials Floorstanding Sluice Sink is a robust, hygienic solution designed for demanding commercial and healthcare environments. Manufactured from high-quality bacteriostatic 304 stainless steel, it delivers long-term durability, ease of cleaning, and reliable performance.

- Floor standing hospital slop for the disposal of waste.
- Constructed from 1.5mm thick bacteriostatic 304 stainless steel.
- Satin polished finish for a clean, professional appearance.
- Smooth, non-porous surface for easy cleaning and improved hygiene.
- Concealed flushing system with a full flushing rim for efficient, hygienic operation.
- Hinged stainless steel bucket grating for safe and practical use
- Concealed drainage with shrouded sink design.
- Horizontal water inlet: Ø 55mm.
- Horizontal water outlet: Ø 100mm.
- External wall fixing flanges for secure installation.
- Quick and easy installation with two removable side access panels.
- Access panels fitted with anti-theft TORX security screws.
- Back entry flushpipe connection.
- Weight: 16kg

Dimensions

- Width: 410mm.
- Depth: 550mm,
- Height: 450mm.

Optional Cistern

- The floorstanding sluice sink can be supplied with an optional concealed plastic cistern, complete with flushpipe and a through-wall front-operated lever for convenient use.

Warranty

- 30-year manufacturer's warranty for peace of mind

Delivery

- In stock.
- Delivery within 2–3 working days.

What is it used for?

The Floorstanding Sluice Sink (Slop Hopper) is designed for the safe and hygienic disposal of liquid waste in commercial, healthcare, and institutional environments. It is commonly used for emptying and rinsing items such as mop buckets, cleaning equipment, bedpans, bottles and clinical waste containers.

Its robust stainless steel construction and concealed flushing system make it ideal for high-use areas where hygiene, durability, and ease of cleaning are essential. Typical applications include hospitals, care homes, laboratories, schools, commercial kitchens, and industrial cleaning areas.

****All pictures shown are for illustration purpose only and may be subject to change without notice. Actual product may vary due to product enhancement.**
All dimensions shown are for guidance only and may be subject to change or alteration without notice. All items manufactured or purchased separately from a third party to fit our products should be checked against the actual dimensions of the physical product before purchase. We will not be liable for third party costs and consequential loss associated with the items not fitting third party components.**